

### **IS POWER GETTING TO THE HEATER?**

*IS THE POWER SWITCH IN THE "UP" POSITION?*

*YOU CAN CONFIRM THIS BY PLUGGING SOMETHING ELSE INTO THE SAME OUTLET AND BE SURE IT POWERS ON.<sup>1</sup>*

*YOU CAN ALSO UNPLUG THE THERMOSTAT AND PLUG THE HEATER DIRECTLY INTO THE OUTLET. THIS SHOULD CAUSE THE HEATER TO RUN CONTINUOUSLY.<sup>2</sup>*

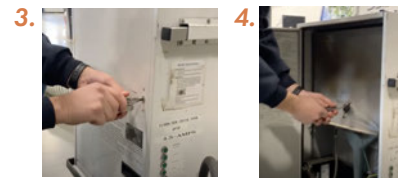

### **IF HEATER STILL DOESNT FUNCTION, CONDUCT A HARD RESET**

*OPEN THE PANEL ON THE NON-VENTILATED END OF THE HEATER WITH A FLAT SCREW-DRIVER:<sup>3</sup> INSIDE THERE IS A SMALL RED RESET BUTTON IN THE CENTER. PRESS IT FIRMLY.<sup>4</sup>*

*TURN THE HEATER OFF AND ON AGAIN.*



*OPEN THE PANEL ON THE VENTILATED END OF THE HEATER WITH A FLAT SCREWDRIVER. INSIDE THERE IS A SMALL RED RESET BUTTON IN THE BOTTOM RIGHT CORNER. PRESS IT FIRMLY.<sup>5</sup>*

*TURN THE HEATER OFF AND ON AGAIN.*

**BE SURE THAT NOTHING IS OBSTRUCTING THE AIRFLOW EITHER AT THE INTAKE VENT ON THE END OF THE HEATER OR ON THE HEAT SIDE. IF THE DUCT GOES AROUND A CORNER OR IS NOT SMOOTH AND STRAIGHT, IT CAN RESTRICT AIRFLOW. IF THAT IS THE CASE, THE OVERHEAT RESET BUTTON MAY POP.**

***If problem still persists, contact Made in the Shade at 916-371-8500***